

# RODOFLEX

## FLEXIBLE COUPLINGS - TORSIONALLY STIFF

**GIUNTO FLESSIBILE**  
TORSIONALMENTE RIGIDI  
PER ENCODER

CORPO IN POLIAMMIDE  
FORI GREZZI

**AMKP 3** - MINIATURA

**AMKP 5** - TAGLIA STANDARD

**FLEXIBLE COUPLINGS**  
TORSIONALLY STIFF  
FOR ENCODERS

POLYAMIDE BODY  
COARSE HUBS

**AMKP 3** - MINIATURE

**AMKP 5** - STANDARD SIZE

**JOINT D'ACCOUPEMENT**  
RIGIDITE A LA TORSION  
POUR CODEURS

CORPS EN POLYAMIDE  
MOYEUX NON FINI

**AMKP 3** - MINIATURE

**AMKP 5** - TAILLE STANDARD

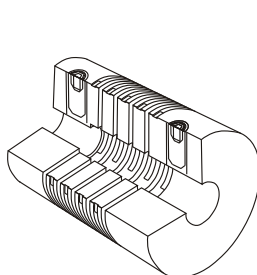

(SEZIONE - SECTION)

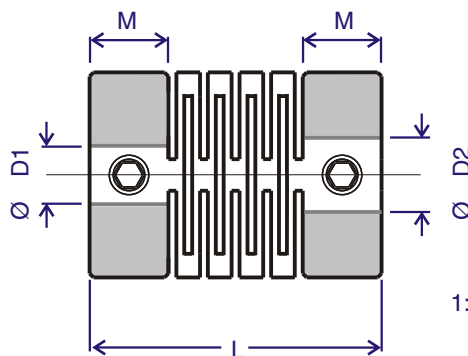

1:1 (AMKP 5)

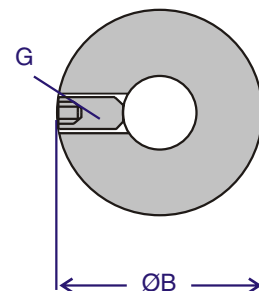

Ø B	L	M	G	D1	D2	D1/D2
mm	mm	mm		standard		max
12,7	22,0	6,9	M3	2,9	4	6,35
26,0	37,5	11,0	M5	5,9	7,5	12,7

coarse  
grezzi  
preforé

### DIMENSIONS DIMENSIONI

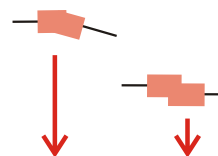
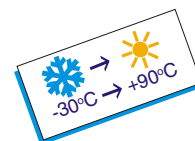

### PERFORMANCE PRESTAZIONI

torque - coppia - couple			disallineamento		g
nominale	alternato	max	ang.	parall.	
Nm	Nm	Nm	°	mm	
0,25	0,13	0,5	5°	0,18	3,1
3,25	1,75	7,0	5°	0,3	23,5

**funzione:** giunto flessibile torsionalmente rigido per la compensazione di disallineamenti assiali tra alberi rotanti

**caratteristiche:** flessibilità assiale, esente da elasticità e gioco radiali

**materiale:** poliammide stampato PA 6.6 Verton RF/700/100 grigio o nero

**foratura:** forniti con fori grezzi; l'utilizzatore può alesare il foro fino al diametro richiesto (AMKP 3, max Ø 6,35 - AMKP 5 max. Ø 12,7 mm)

2 grani filettati in acciaio a testa cava esagonale M5 per bloccaggio alberi

**task:** flexible coupling, torsionally stiff, zero radial back-lash; used for compensating misalignment between rotating shafts

**features:** axial flexibility, no clearance, no radial backlash

**material:** moulded polyamide PA 6.6 Verton RF/700/100 gray or black

**bore:** supplied with coarse hub bores; end user can drill the hub up required diameter (AMKP 3, max Ø 6,35 mm - AMKP 5 max. Ø 12,7 mm)

2 steel setting hex-socket screws for shaft locking

**emploi:** joint d'accouplement pour la compensation du désalignement axial entre arbres en rotation

**caractéristiques:** flexibilité axiale, rigidité à la torsion, sans jeu radial

**construction:** polyamide injecté PA 6.6 Verton RF/700/100 gris ou noir

**perçage:** les joints sont livrés pre-forés; l'utilisateur peut aléser jusqu'au diamètre nécessaire (AMKP 3, max. Ø 6,35 mm - AMKP 5 max. Ø 12,7 mm)

2 vis à six pans M5 en acier pour le blocage des arbres