

RODOFLEX

FLEXIBLE COUPLINGS - TORSIONALLY STIFF

GIUNTO FLESSIBILE
TORSIONALMENTE RIGIDI
TRASMISSIONE DI POTENZA

FLEXIBLE COUPLINGS
TORSIONALLY STIFF
POWER TRANSMISSION

JOINT D'ACCOUPEMENT
RIGIDITE A LA TORSION
TRANSMISSION DE PUISSANCE

ATMN..

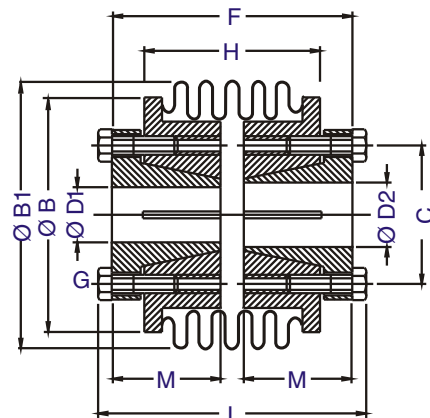
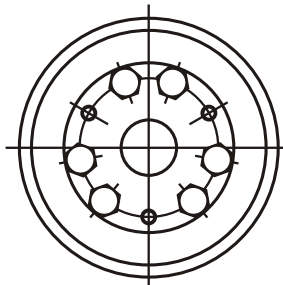

TIPO TYPE TYPE	Ø D ¹ – D ² MIN MAX mm	Ø B mm	Ø B1 mm	L mm	M mm	C	F mm	H mm	G
ATMN 15 .. L58	8 => 19	51,5	56	57,6	23,5	30	52	41	M4
ATMN 20 .. L58	8 => 19	51,5	56	57,6	23,5	30	52	41	M4
ATMN 30 .. L74	14 => 22	58	66	74	28	36	66	50	M6
ATMN 30 .. L88	14 => 22	58	66	88	28	36	80	64	M6
ATMN 60 .. L74	14 => 22	58	66	74	28	36	66	50	M6
ATMN 60 .. L88	14 => 22	58	66	88	28	36	80	64	M6
ATMN 80 .. L76	18 => 35	72	82	76	29	50	68	50	M6
ATMN 80 .. L90	18 => 35	72	82	90	29	50	82	64	M6
ATMN 170 .. L76	18 => 35	72	82	76	29	50	68	50	M6
ATMN 170 .. L90	18 => 35	72	82	90	29	50	82	64	M6
ATMN 270 .. L87	26 => 41	93	101	87	36	62	76	52	M8
ATMN 320 .. L87	26 => 41	93	101	87	36	62	76	52	M8

Ø FORI STANDARD tol. G7

STANDARD Ø BORES tol. G7

Ø ALESAGES STANDARD tol. G7

TIPO/TYP	8	9	9,52 3/8"	10	11	12	12,7 1/2"	14	15	16	17	18	19	20	22
ATMN 15 .. L58	8	9	9,52	10	11	12	12,7	14	15	16	17	18	19		
ATMN 20 .. L58	8	9	9,52	10	11	12	12,7	14	15	16	17	18	19		
ATMN 30 .. L74								14	15	16	17	18	19	20	22
ATMN 30 .. L88								14	15	16	17	18	19	20	22
ATMN 60 .. L74								14	15	16	17	18	19	20	22
ATMN 60 .. L88								14	15	16	17	18	19	20	22
TIPO/TYP	18	19	20	22	24	25	26	28	30	32	35	38	40	41	
ATMN 80 .. L76	18	19	20	22	24	25	26	28	30	32	35				
ATMN 80 .. L90	18	19	20	22	24	25	26	28	30	32	35				
ATMN 170 .. L76	18	19	20	22	24	25	26	28	30	32	35				
ATMN 170 .. L90	18	19	20	22	24	25	26	28	30	32	35				
ATMN 270 .. L87							26	28	30	32	35	38	40	41	
ATMN 320 .. L87							26	28	30	32	35	38	40	41	

GIUNTO FLESSIBILE TORSIONALMENTE RIGIDI TRASMISSIONE DI POTENZA

- ① COPPIA NOMINALE
- ② DISALLINEAMENTO PARALLELO
- ③ DISALLINEAMENTO IN DISTANZA
- ④ DISALLINEAMENTO ANGOLARE
- ⑤ RIGIDITA' TORSIONALE
- ⑥ MOMENTO D'INERZIA
- ⑦ MOMENTO SERRAGGIO VITI

FLEXIBLE COUPLINGS TORSIONALLY STIFF POWER TRANSMISSION

- ① NOMINAL TORQUE
- ② PARALLEL MISALIGNMENT
- ③ AXIAL DISPLACEMENT
- ④ ANGULAR MISALIGNMENT
- ⑤ TORSIONAL STIFFNESS
- ⑥ MOMENT OF INERTIA
- ⑦ SCREW TIGHTENING TORQUE

JOINT D'ACCOUPEMENT RIGIDITE A LA TORSION TRANSMISSION DE PUISSANCE

- ① COUPLE NOMINAL
- ② MESALIGNEMENT PARALLEL
- ③ DEPLACEMENT AXIAL
- ④ MESALIGNEMENT ANGULAIRE
- ⑤ RIGIDITE' EN TORSION
- ⑥ MOMENT D'INERTIE
- ⑦ MOMENT SERRAGE DES VIS

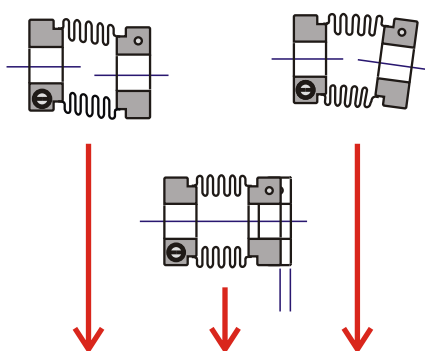

AVVERTENZE DI MONTAGGIO IMPORTANTI

cf. pag. 17

IMPORTANT MOUNTING INSTRUCTION

see page 17

AVIS DE MONTAGE IMPORTANT

voir page 17



TIPO TYPE TYPE	(1) Nm	(2) PARALL. mm	(3) DIST. mm	(4) ANG. a°	(5) 10 ³ Nm/rad	(6) 10 ⁻³ kgm ²	(7) Nm	 kg
ATMN 15 .. L58	10	0,15	0,30	1,0°	15	0,13	4	0,440
ATMN 20 .. L58	20	0,15	0,30	1,0°	28	0,14	4	0,460
ATMN 30 .. L74	30	0,15	0,30	1,0°	25	0,34	12	0,760
ATMN 30 .. L88	30	0,15	0,30	1,0°	25	0,37	12	0,805
ATMN 60 .. L74	60	0,15	0,30	1,0°	42	0,37	12	0,805
ATMN 60 .. L88	60	0,15	0,30	1,0°	42	0,42	12	0,855
ATMN 80 .. L76	80	0,20	0,35	1,5°	45	0,88	12	1,310
ATMN 80 .. L90	80	0,20	0,35	1,5°	45	0,90	12	1,340
ATMN 170 .. L76	170	0,20	0,35	1,5°	90	0,98	12	1,370
ATMN 170 .. L90	170	0,20	0,35	1,5°	90	1,02	12	1,415
ATMN 270 .. L87	270	0,20	0,50	2,0°	150	2,65	30	2,560
ATMN 320 .. L87	320	0,20	0,50	2,0°	190	2,88	30	2,670

soffietto metallico:

in acciaio inox 1.4541, saldato ai mozzi

mozzi: acciaio inox 1.4305, boccola acciaio 1.7227

fori mozzi:

combinazione di Ø standard, cfr. tabella pag. 10, finiti toll. G7

esempio sigla: tipo ATMN 80, foro D1 Ø 20 mm, foro D2 24 mm, lunghezza totale 90 mm

--> **ATMN 80-20-24 L90**

metallic bellows:

stainless steel 1.4541, welded to hubs

hubs: stainless steel 1.4305, conical sleeve steel 1.7227

hub bores:

combination of standard Ø, see pag. 10, finished tol. G7

part numbers: type ATMN 80, bore D1 Ø 20 mm, bore D2 24 mm, overall length 90 mm

--> **ATMN 80-20-24 L90**

soufflet metallique:

àcier inoxydable 1.4541, soudé aux moyeux

moyeux: àcier inoxydable 1.4305, bague conique àcier 1.7227

alésage des moyeux:

combinaison de Ø standard, voir pag. 10, finis tol. G7

exemple de commande: type ATMN 80, alésage D1 Ø 20 mm, alésage D2 24 mm, longueur total 90 mm

--> **ATMN 80-20-24 L90**